

6M-20 CARBURETORS

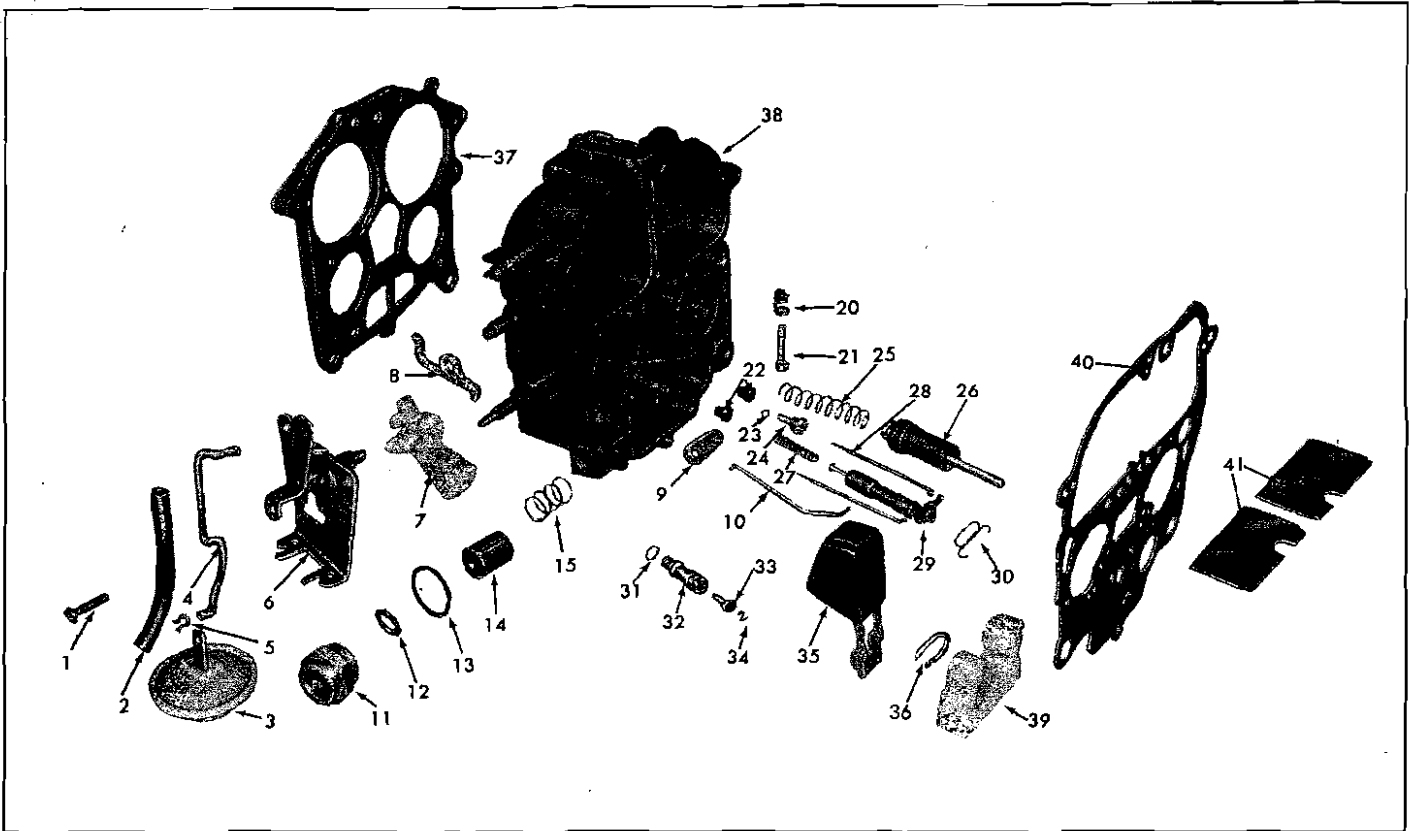

Fig. 35R - Float Bowl - Exploded View

- | | | | |
|-----------------------------------|----------------------------------|-----------------------------------|------------------------------|
| 1. Screw—Choke Control | 11. Nut—Fuel Inlet | 25. Spring—Pump Return | 33. Needle—Float |
| 2. Hose—Vacuum Break | 12. Gasket—Fuel Filter | 26. Pump Assembly | 34. Pull Clip—Float Needle |
| 3. Vacuum Break | 13. Gasket—Fuel Inlet Nut | 27. Spring—Power Piston | 35. Float Assembly |
| 4. Link—Vacuum Break | 14. Filter—Fuel Inlet | 28. Metering Rod—Primary | 36. Hinge Pin—Float Assembly |
| 5. Clip—Vacuum Break Rod | 15. Spring—Fuel Filter | 29. Power Piston Assembly—Primary | 37. Gasket—Throttle Body |
| 6. Bracket Assembly—Choke Control | 20. Spring—Idle Speed Screw | 30. Spring—Metering Rod Primary | 38. Float Bowl Assembly |
| 7. Cam—Fast Idle | 21. Screw—Idle Speed | 31. Gasket—Float Needle Seat | 39. Insert—Float Bowl |
| 8. Lever—Secondary Lock Out | 22. Jet—Primary | 32. Seat—Float Needle | 40. Gasket—Air Horn |
| 9. Lever—Choke Intermediate | 23. Ball—Pump Discharge | | 41. Baffle—Float Bowl |
| 10. Rod—Choke | 24. Retainer—Pump Discharge Ball | | |

erly located over dowels on float bowl then install throttle body to bowl screws and tighten evenly and securely.

Place carburetor on proper holding fixture.

3. Install fuel inlet filter spring, filter, new gasket and inlet nut and tighten nut securely.

NOTE: If vacuum break diaphragm was removed from bracket, slide vacuum break diaphragm between retaining ears to hold securely. Install vacuum break rod (U-bend end) in diaphragm link with end towards bracket then install grooved end of rod in hole of actuating lever and retain to vacuum break lever with spring clip.

4. Install fast idle cam on vacuum break assembly. Be sure fast idle cam pick up lever on intermediate choke shaft is located in cut out area of fast idle cam.
5. Connect choke rod to choke rod actuating lever (plain end) then holding choke rod, with grooved end pointing inward, position choke rod actuating lever in well of float

bowl and install choke assembly engaging shaft with hole in actuating lever (fig. 37R). Install retaining screw and tighten securely. Remove choke rod from lever for installation later.

6. Install vacuum hose to tube connection on bowl and vacuum break assembly.
7. Install air deflector in secondary side of bowl with notches towards top.
8. Install pump discharge check ball and retainer in passage next to pump well.
9. Install primary main metering jets.
10. Install fuel inlet needle seat and gasket. Use wide blade screw driver to avoid distortion. Install fuel inlet needle.
11. Using needle nosed pliers to hold needle pull clip, install pull clip on needle. Pull clip is properly positioned with open end towards front of bowl.
12. Install float by sliding float lever under pull clip from front to back. With float lever in pull clip, hold float assembly at toe and install retaining pin from pump well side. Be careful not to distort pull clip.