

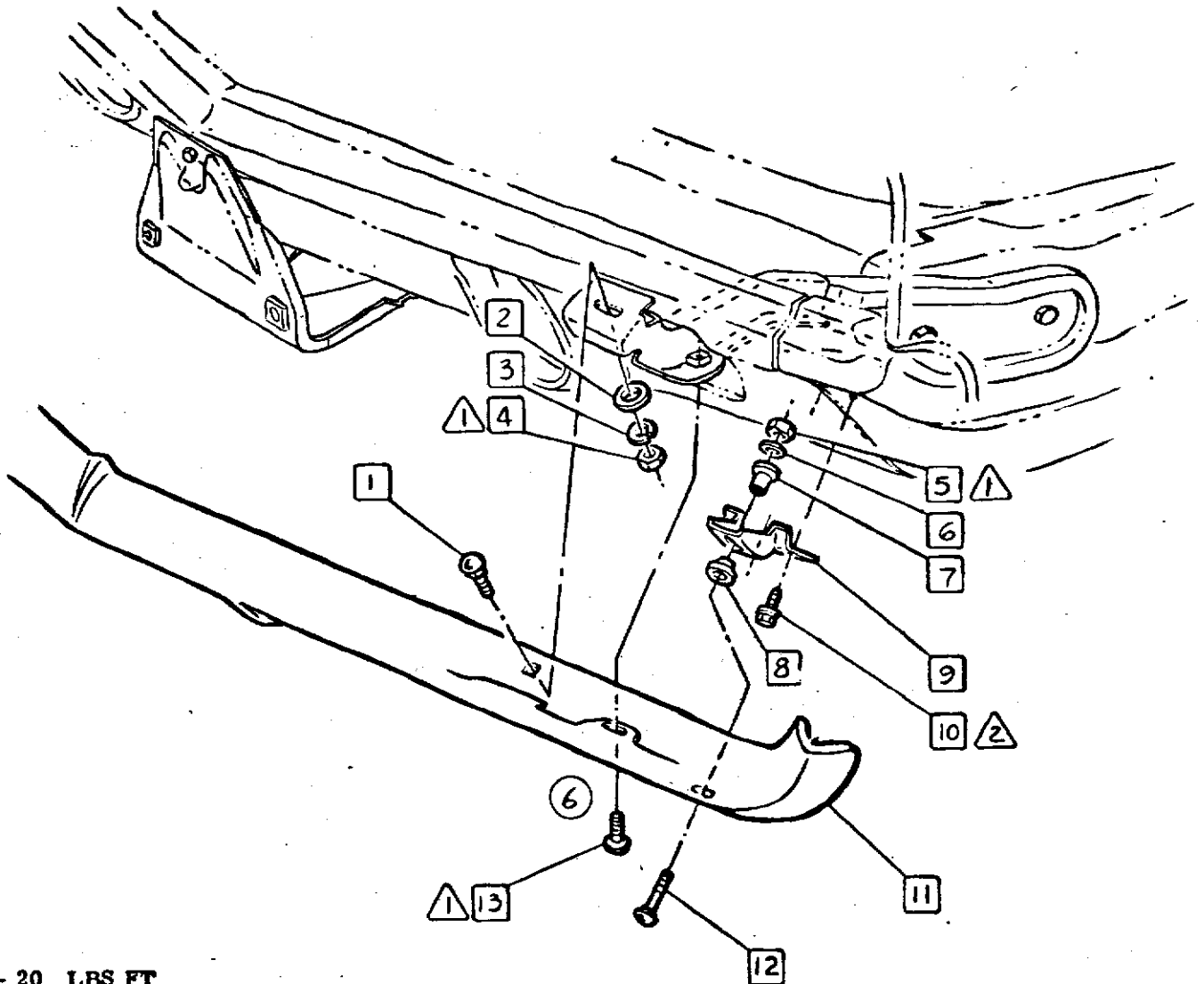

- 1 6255899 BOLT
- 2 120394 P. WASHER
- 3 103321 L. WASHER
- 4 9418931 NUT
- 5 9425691 NUT
- 6 128144 P. WASHER
- 7 3945760 CUSHION ASM
- 8 3943275 CUSHION

- 9 3945769-70 BRACKET-L. & R.H.
- 10 3918503 SCREW ASM
- 11 3927422 BAR
- 12 3945758 BOLT
- 13 3872455 SCREW ASM

NOTE Assemble item 9 to item 11 before assembling to body.



- ① Δ 14 - 20 LBS FT
- Δ 15 - 22 LBS FT
- Δ
- Δ

CHEVROLET MOTOR DIVISION, GMC		UPC	DATE	SYM	REVISION RECORD	AUTH.	DR	CK
FRONT BUMPER	12000	14	5-14-68	1	TORQUES ADDED	13823	EL	
		A3	5-31-68	2	WAS 103341 WASHER		EL	H/S
			8-1-68	3	ITEM 8 RELOCATED	97076	JG	KB
			9-27-68	4	ITEM 14 ADDED	96468	CD	
				5	WAS 9425379 SCREW			
				6	103321 LN REMOVED			
			1-7-69	7	3949753-4 FILLER RMVD	23260	CD	H/S
DWG Peel 2 of 2 REF: Prel. A3 L-86182 L- DATE PREL 4-27-68 + L- L- L-		SHEET						